

Gewindereduzierstutzen

DN DIN	D1	D2	D5	E	L	Art.Nr. 304	Art.Nr. 316
25/15	16	19	26	Rd 52 x 1/6"	26	126020251015	126020253015
32/25	26	29	32	Rd 58 x 1/6"	27	126020321025	126020323025
40/25	26	29	38	Rd 65 x 1/6"	28	126020401025	126020403025
40/32	32	35	38	Rd 65 x 1/6"	29	126020401032	126020403032
50/32	32	35	50	Rd 78 x 1/6"	29	126020501032	126020503032
50/40	38	41	50	Rd 78 x 1/6"	35	126020501040	126020503040
65/40	38	41	66	Rd 95 x 1/6"	39	126020651040	126020653040
65/50	50	53	66	Rd 95 x 1/6"	40	126020651050	126020653050
80/50	50	53	81	Rd 110 x 1/4"	45	126020801050	126020803050
80/65	66	70	81	Rd 110 x 1/4"	46	126020801065	126020803065
100/65	66	70	100	Rd 130 x 1/4"	49	126021001065	126021003065
100/80	81	85	100	Rd 130 x 1/4"	49	126021001080	126021003080

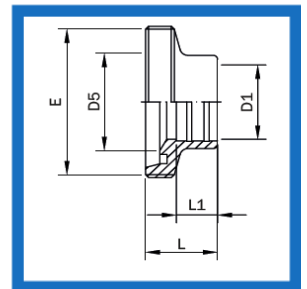

Gewindereduzierstutzen Einwalz

DN DIN	D1	L1	D5	E	L	Art.Nr. 304	Art.Nr. 316
25/15	18,2	12	26	Rd 52 x 1/6"	27	126030251015	126030253015
32/25	28,2	15	32	Rd 58 x 1/6"	30	126030321025	126030323025
40/25	28,2	15	38	Rd 65 x 1/6"	30	126030401025	126030403025
40/32	34,2	18	38	Rd 65 x 1/6"	32	126030401032	126030403032
50/32	34,2	18	50	Rd 78 x 1/6"	34	126030501032	126030503032
50/40	40,2	20	50	Rd 78 x 1/6"	35	126030501040	126030503040
65/40	40,2	20	66	Rd 95 x 1/6"	39	126030651040	126030653040
65/50	52,2	22	66	Rd 95 x 1/6"	40	126030651050	126030653050
80/50	52,2	22	81	Rd 110 x 1/4"	45	126030801050	126030803050
80/65	70,3	25	81	Rd 110 x 1/4"	48	126030801065	126030803065
100/65	70,3	25	100	Rd 130 x 1/4"	57	126031001065	126031003065
100/80	85,3	28	100	Rd 130 x 1/4"	57	126031001080	126031003080