

Gewinde-Aufschraubstutzen

DN DIN	D1	L	L1	E	E1	SW	Art.Nr. 304 pol.	Art.Nr. 316 pol.
10	10	30	14	Rd 28 x 1/8"	G 3/8"	19	129000101	129000103
15	16	30	14	Rd 34 x 1/8"	G 1/2"	24	129000151	129000153
20	20	30	14	Rd 44 x 1/6"	G 3/4"	30	129000201	129000203
25	26	35	20	Rd 52 x 1/6"	G 1"	41	129000251	129000253
32	32	35	20	Rd 58 x 1/6"	G 1 1/4"	46	129000321	129000323
40	38	35	20	Rd 65 x 1/6"	G 1 1/2"	50	129000401	129000403
50	50	35	20	Rd 78 x 1/6"	G 2"	65	129000501	129000503
65	66	38	22	Rd 95 x 1/6"	G 2 1/2"	80	129000651	129000653
80	81	43	25	Rd 110 x 1/4"	G 3"	95	129000801	129000803
100	100	50	30	Rd 130 x 1/4"	G 4"	117	129001001	129001003

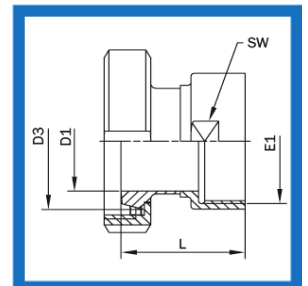

Kegel-Aufschraubstutzen

DN DIN	D1	D3	L	E1	SW	Art.Nr. 304 pol.	Art.Nr. 316 pol.
10	10	22,5	39	G 3/8"	19	130000101	130000103
15	16	28,5	41	G 1/2"	24	130000151	130000153
20	20	36,5	42	G 3/4"	30	130000201	130000203
25	26	44	52	G 1"	41	130000251	130000253
32	32	50	55	G 1 1/4"	46	130000321	130000323
40	38	56	56	G 1 1/2"	50	130000401	130000403
50	50	68,5	58	G 2"	65	130000501	130000503
65	66	86	64	G 2 1/2"	80	130000651	130000653
80	81	100	74	G 3"	95	130000801	130000803
100	100	121	89	G 4"	117	130001001	130001003